

INSTRUCTIONS  
for USE

INSTALLATION  
INSTRUCTIONS

**VACUUM-TOILET for RECREATIONAL VEHICLES**

---

**VT 2500**



---

English

CE

e 1

**These operating instructions should be kept in a safe place.  
If this device is passed on, please include these operating instructions with it.**

# TABLE OF CONTENTS

	<b>INSTRUCTIONS</b>	
1.0	<b>INTRODUCTION</b>	<b>4</b>
2.0	<b>FOR YOUR SAFETY</b>	<b>4</b>
	2.1 Warning and safety notices	4
3.0	<b>WARRANTY and CUSTOMER SERVICE</b>	<b>4</b>
	3.1 Damage in transit	4
4.0	<b>DESCRIPTION OF MODEL</b>	<b>4</b>
5.0	<b>INSTRUCTIONS for USE</b>	<b>5</b>
	5.1 Putting into operation	5
	5.2 Removing the cassette	6
	5.3 Flushing the toilet	6
	5.4 Cleaning	6
	5.5 Putting out of operation	7
	5.6 Declaration of conformity	8
	<b>INSTALLATION GUIDE</b>	
6.0	<b>Installation</b>	<b>10</b>
	6.1 Fixation of the rear wall of the base station	10
	6.2 Fixation of the floor plate of the base station	11
	6.3 Fixation of the toilet	11
	6.4 Inserting the cassette	11
	6.5 Connecting pipes	12
	6.6 Water supply	13
	6.7 Electrical installation	13
	6.8 Data sheet	14
	6.9 Wiring diagram	15

# 1.0

# INTRODUCTION

Dometic

# 2.0

# FOR YOUR SAFETY

## 2.1



## Warning and safety notices

DANGER ATTENTION

- When operating the flushing system, always keep the seat lid closed.
- Do NOT press the pedal during cleaning or whilst the lid is open.

# 3.0

# WARRANTY and CUSTOMER SERVICE

## 3.1

## Damage in transit

# 4.0

# DESCRIPTION of MODEL

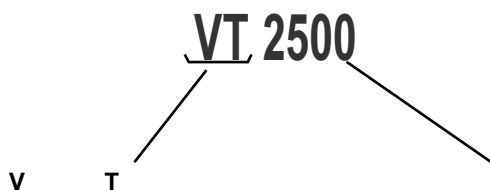

# 5.0

## 5.1

# OPERATION

## Putting into operation

First check whether:

yellow LED

green LED

By lifting the pedal allow a little water to enter the toilet, so that the closure on the base of the receptacle is covered.

The system is ready for operation!

### Display panel

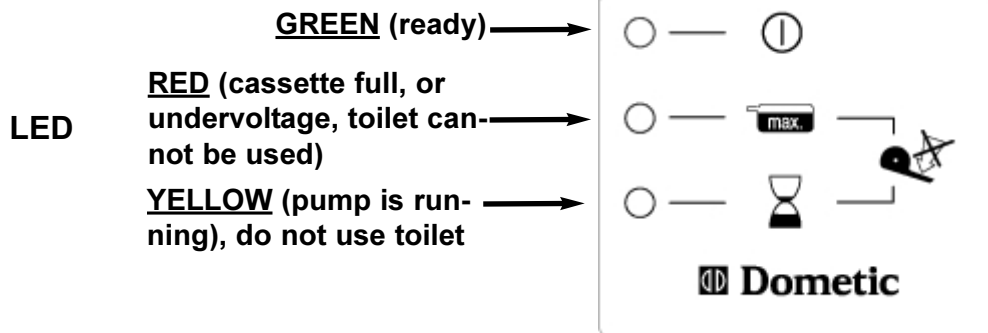

red LED

△ It cannot be used further until the cassette has been emptied or the correct voltage has been restored.

## 5.2

## Flushing the toilet

△ The toilet may only be flushed whilst the green LED is illuminated.

close the seat lid

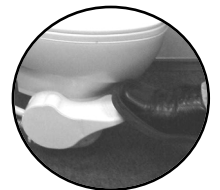

0.4 L

**Only use commercially available toilet paper with 2 layers.**  
 Since the system always operates under a vacuum and is closed hermetically, no smell can develop.

 **Never press the pedal whilst sitting on the toilet or if the seat lid is open!**

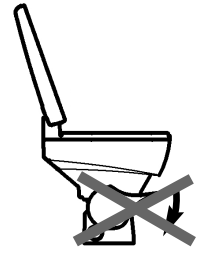

 **For the environment's sake, do not use any chemicals.**

 **Do not dispose any solid or non-dissolving objects such as plastic cans or paper towels in the toilet. These items can cause damage or plugging of the system !**



## 5.3

### Removing the cassette

To remove the cassette, raise the locking latch (A) underneath the grip. Pull out the the cassette using the carrying grip (B).

When inserting the cassette again, make sure that it is inserted exactly in the opening provided and that after pushing it in, the locking latch has notched again.

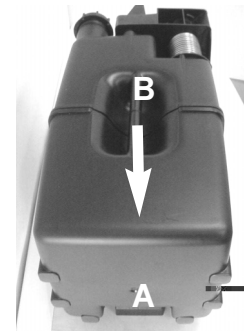
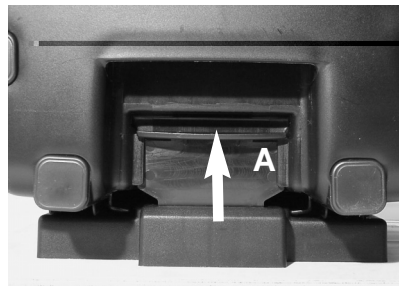

## 5.4

### Cleaning

Since the toilet receptacle is made of ceramic material, you can clean it in the same way as a household toilet.

For cleaning the plastic parts (such as the lid, seat, outer covering) please only use water with a mild cleaning agent. If possible, rinse the cassette with fresh water each time it has been emptied.

To avoid deposits clean also the flush ball (Fig. 1) and the sealing ring (Fig. 2 with the flush ball opened)

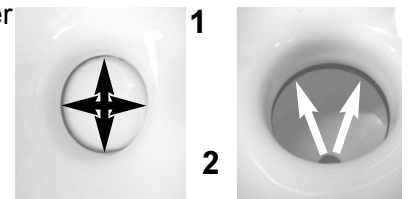

Occasional clean the area where the excrements are transferred at the connection (Fig. 3) and on the base station (Fig. 4-5).

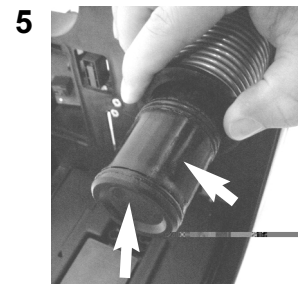
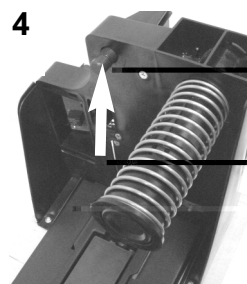
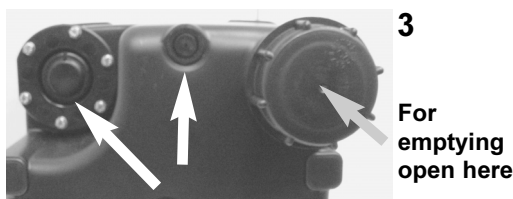

## 5.4.1

### Changing the filter

filter

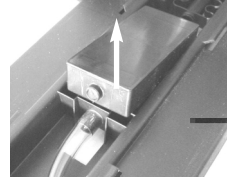
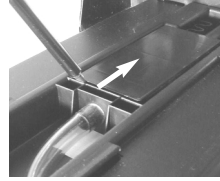
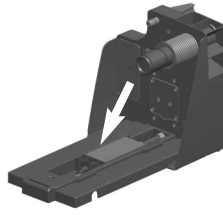
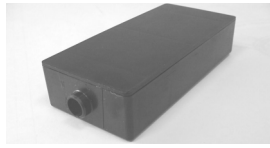

## 5.5

### Putting out of operation

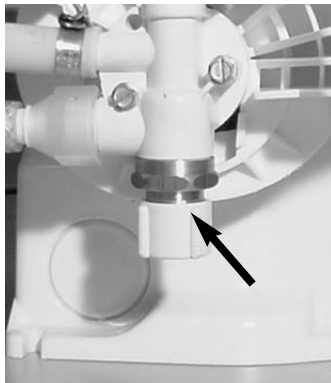

water feed turned off

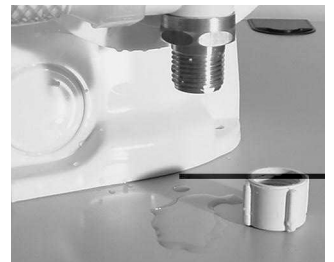
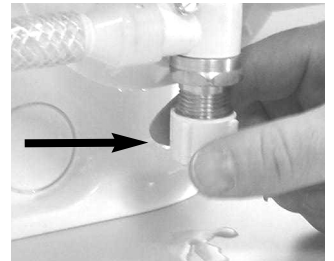

# Declaration of conformity



## DECLARATION OF CONFORMITY

according to

EMC Directive 89/336/EEC  
Automotive Directive 72/245/EEC and  
the Amendment 95/54/EC  
CE Marking Directive 93/68/EEC

<b>Type of equipment</b>	Vacuum toilet
<b>Brand Name</b>	DOMETIC
<b>Type no.</b>	VT 2500 R VT 2500 L VT 2501 R VT 2501 L
<b>Manufacturer's (Factory) name</b>	DOMETIC GmbH
<b>address</b>	In der Steinwiese 16, D-57074 Siegen
<b>telephone no</b>	INT+49 - 271 692 0
<b>telefax no</b>	INT+49 - 271 692 304

The following harmonized standards or technical specifications (designations) which comply with good engineering practice in safety matters in force within the EEA have been practiced:

**EN 55014-1, EN 55014-2 EMC Directive**

The equipment conforms completely with the above stated harmonized standards or technical specifications.

By signing this document, ~~the undersigned declares as manufacturer or the manufacturer's~~ authorized representative established within the EEA, that the equipment in question complies with the requirements stated above.

Manufacturer

Date	Signature	Position
2003.01.06	 Gunther Bittner	General Manager





# 6.0

## INSTALLATION

The vacuum toilet is intended for installation in caravans or motor homes.

### Delivery includes:



Toilet

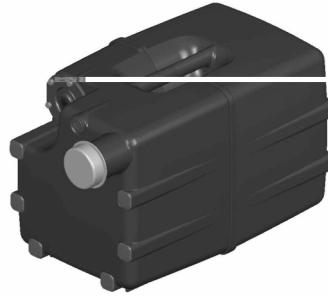

Vacuum cassette

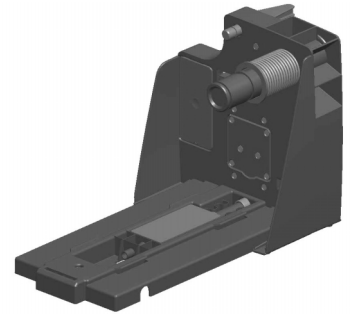

Base station (complete with base plate and rear wall)

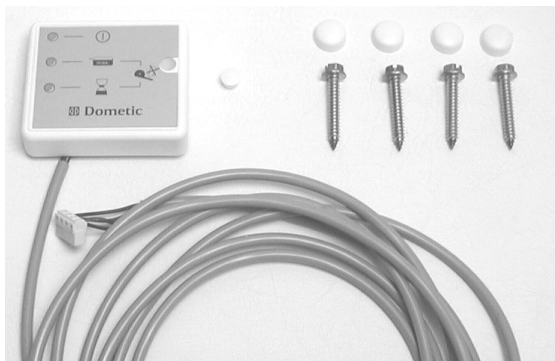

Display panel with connection cable  
1 cap  
4 screws and caps

### 6.1

## Fixation of the rear wall of the base station

 **The base plate and the rear wall must be assembled on the same vehicle element!**

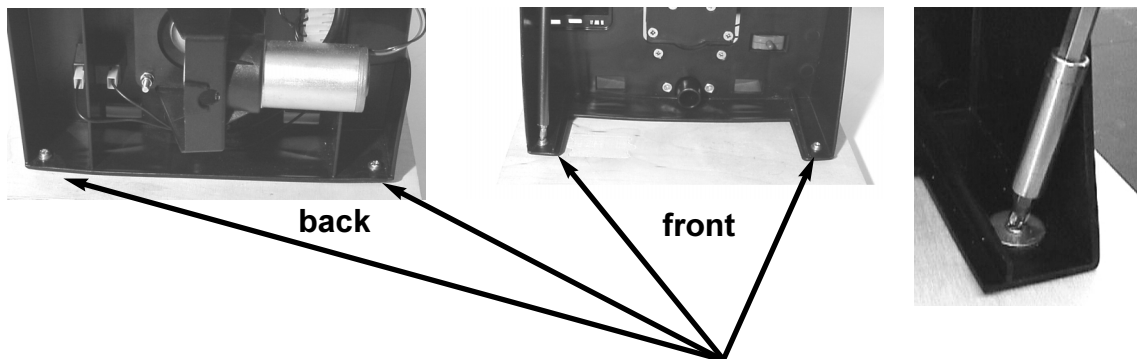

1. The rear wall of the base station is mounted on a level floor at right angles to the outer door using all 4 screws.  
The floor must be strong enough to support the weight of the cassette.

## 6.2

### Fixation of the floor plate of the base station

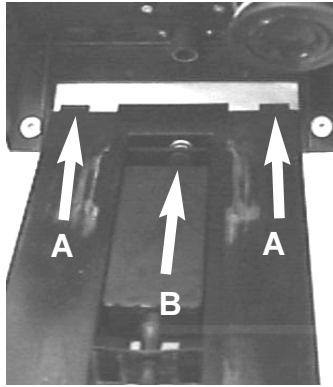

1. The floor plate of the base station is fixed to the rear wall.  
The floor has two lugs (A), that have to be pushed into the respective gaps in the rear wall of the base station.

 Make sure that the connection (B) for the carbon filter fits into the place provided!

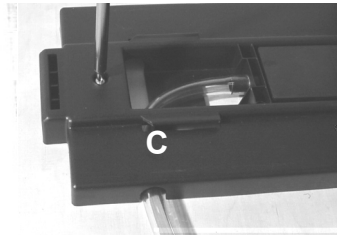
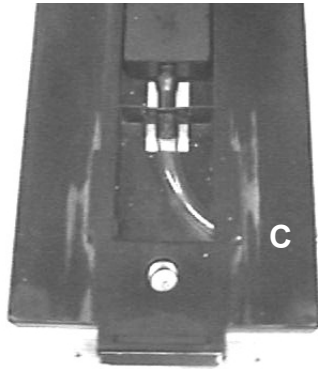

2. The floor plate of the base station is screwed to the floor of the vehicle.
3. The ventilation hose (C) is conducted through the vehicle floor to the exterior.

## 6.3

### Fixation of the toilet



**Distance to the rear wall : min. 50 mm**

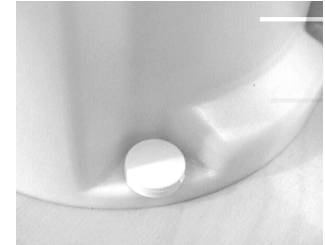

1. The toilet must be installed horizontally.
2. Use the screws included in the delivery for fastening it to the floor of the vehicle.
3. The screws are then covered with the four caps.

## 6.4

### Inserting the cassette

The floor and the cassette are in dovetail design.

The cassette can easily be pushed into this opening until the lock in the groove (D) notches.

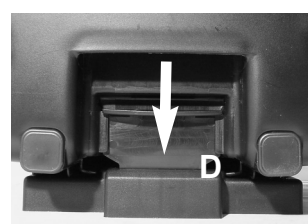
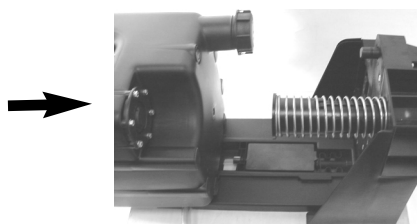

## 6.5

# Connecting pipes

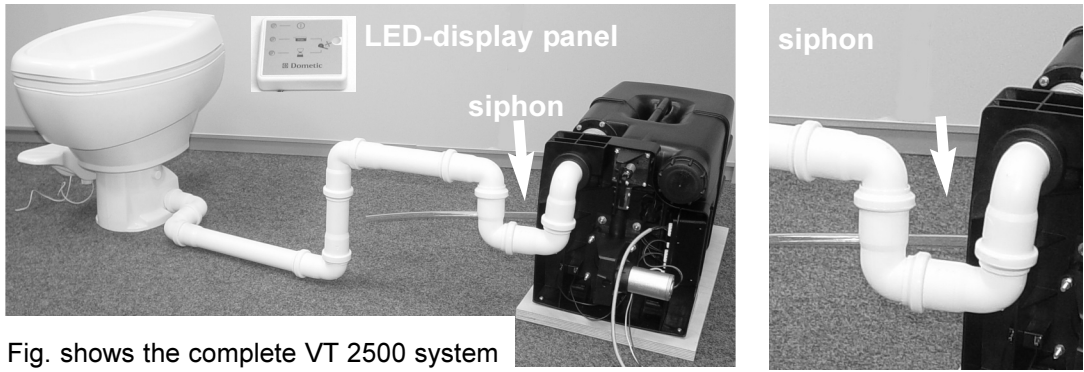
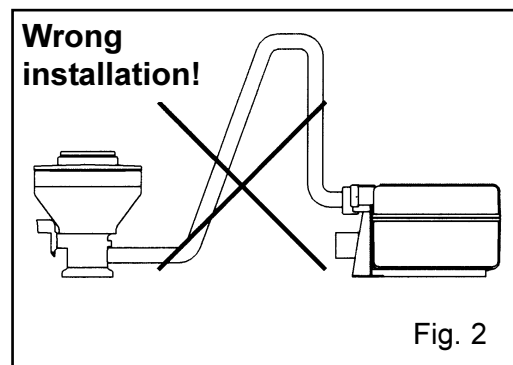
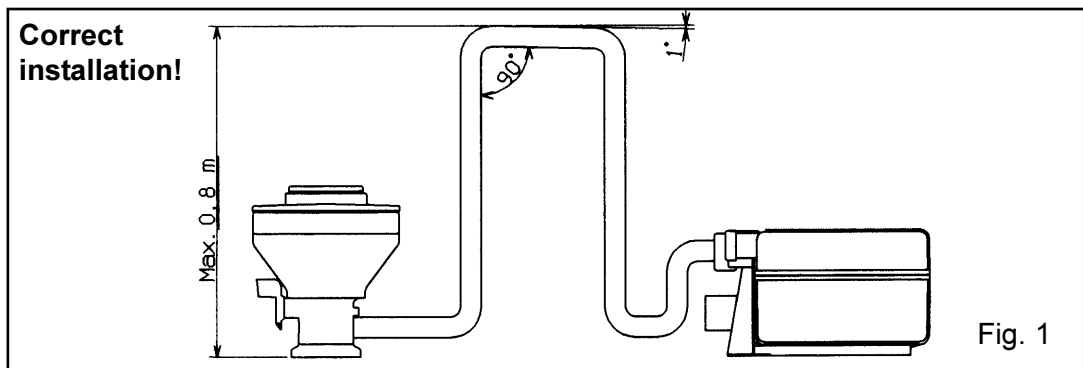

Fig. shows the complete VT 2500 system with pipe connection on the right-hand side (pipe connection on the left-hand side, optional)

- △ - The installation of the connecting pipes (DN 40) from the vacuum cassette to the toilet must be completely airtight and include a siphon!
- **The maximum length of the pipes from the toilet to the cassette is approx. 7 m!**
- If the pipes have to be shortened for laying purposes, the place where it is sawn must be deburred and the pipes chamfered from the outside.
- The laid pipes must be fastened without any strain with a pipe clip (40x15) approx. every 0.8 m.
- The maximum difference in height of the pipe connections from the toilet to the cassette must not exceed 0.8 m (see Fig. 1).  
Always lay the pipes at **right angles!**
- The horizontally laid pipes must be installed with an incline of approx. **1°** from the toilet to the cassette (see Fig. 1)!



## 6.6

### Water supply

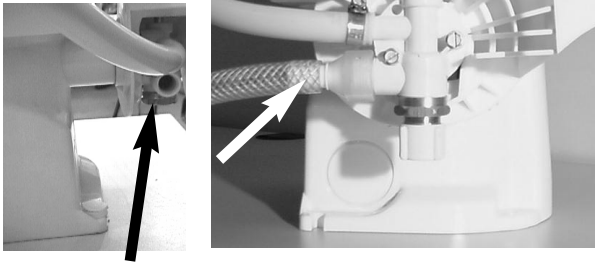

The water supply is provided with the aid of a pump (this can also be the pump available in the vehicle) and a hose connection from the fresh-water container.

Fasten a hose clamp to the water-supply connection.

### Electrical installation

## 6.7

**⚠ Electrical installation must be carried out by qualified personnel only !**

The 12V DC connection to the toilet electronics is shown in the adjacent figure.

The 2-pole connection cable is connected to the electronics as shown in the figure.

The connection cable must have a cross-section of at least 4 mm<sup>2</sup>.

The connection cable must be protected by an 8 amp fuse. The connection should be made directly to the board battery.

The board battery should be protected by an undervoltage cut-out.

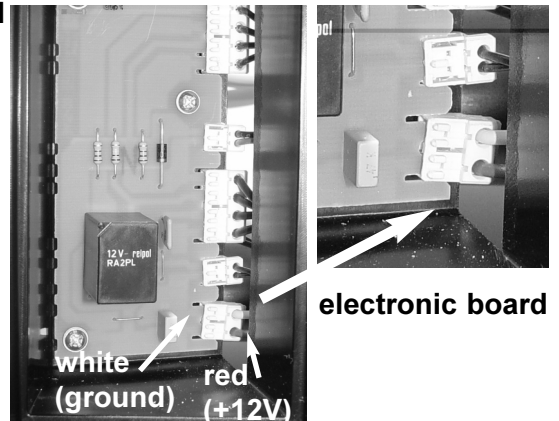

## 6.7.1

### Connection display on the control electronics

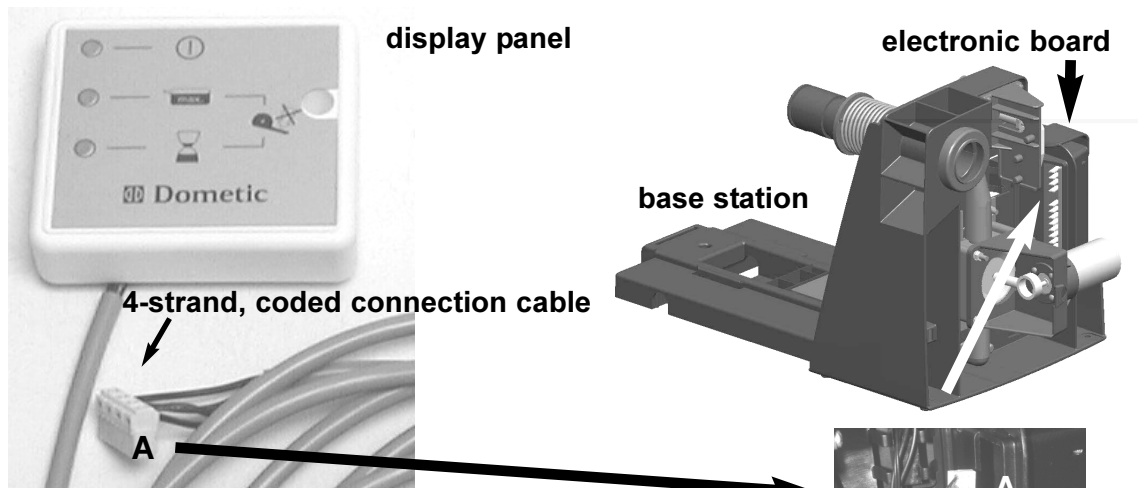

The 4-strand, coded connection cable (A) (cable cross-section 1 mm<sup>2</sup>) is connected to the circuit board as shown in the figures.

## 6.7.2

### Microswitch connection

For vehicles that are not equipped with a pressurized water system, a toilet with integrated microswitch for controlling a pump must be installed.

The microswitch (A) is connected in the circuit of the submersible pump so that the pump is activated via the microswitch when the pedal is pressed.

**Connection cable to the pump with two wires**

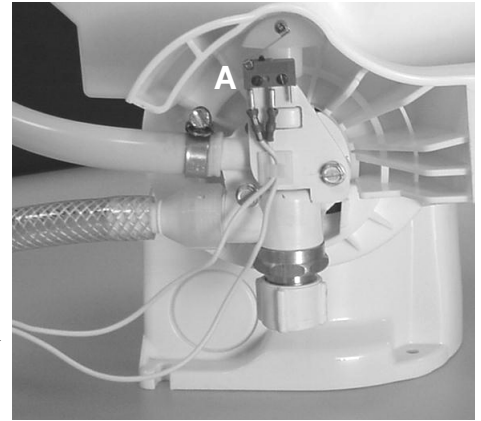

This connection is not necessary in vehicles with a pressure controlled pump.

## 6.8

### Data sheet

**Voltage supply:**

12 V direct current,  
Undervoltage fuse to be provided for on the vehicle.

**Current consumption:**

1.5 A whilst the pump is running

**Pump running time:**

max. 60-70 sec. (depending on cassette content and length of pipes laid)

**Total cassette content:**

approx. 25 litres

**Of this cassette content, excrements:**

approx. 14 litres

**Chemical additives:**

not required

**Toilet paper:**

use with a max. of 2 layers

**Changing the filter:**

depending on frequency used, at the latest every 3 years.

**Dimensions:**

toilet 420 x 350 x 430

(H x W x D in mm)

base station with container 302 x 269 x 548

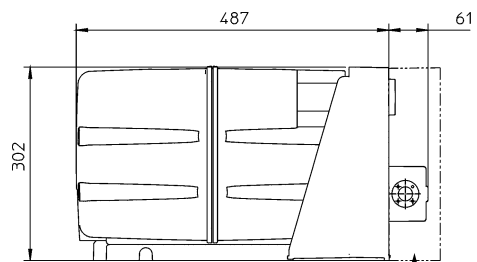
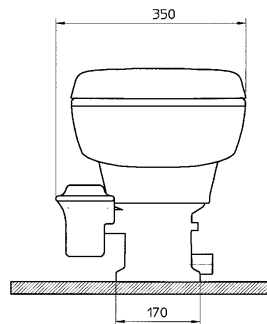

area for siphon and pipes depending on built-in-situation (ch. "6.5")

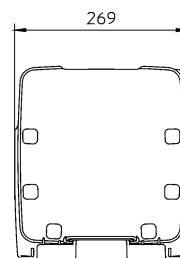
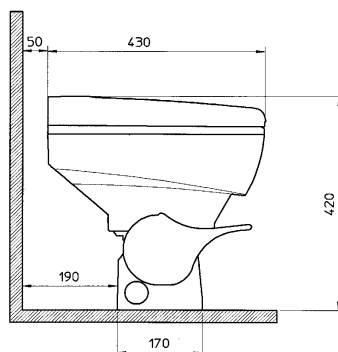

# Wiring diagram

1. Reed-Kontakt  
reed-contact
2. Taster Kassette  
switch cassette

VT 2500



**The power supply must comply with the following performance data:**

Vehicle battery:

Voltage > 11.5 Volt

Peak current (short-term) 8 Amp. Use slow-acting fuse in the feed line!

These values are reached in the standard vehicle batteries.

**Power pack:**

When using a controlled fixed-voltage power pack (e.g. for application in weekend homes) one should similarly make sure that these values are adhered to. Normal rated voltage for power packs with 13.8 V at 6 A.

The control electronics are equipped with an overload protection (Poly Switch). This fuse protects the motor against excessively high currents (e.g. also for older or badly serviced batteries, that supply less than the required minimum voltage of 11.5 Volt ). Should this fuse be activated (red LED illuminates on the control display), it is necessary to check the power supply and ensure that the given values are adhered to.

After a RESET (short-term interruption of the electric circuit, e.g. by removing the cassette) and a short cooling-down period (approx. 1 min) the system is ready for .



Dometic AB  
Torggatan 8  
S-17154 Solna

Tel.: +46- 8 501 025 00  
Fax.: +46- 8 501 025 98  
[www.dometic.com](http://www.dometic.com)

Dometic GmbH  
In der Steinwiese 16  
D-57074 Siegen

Tel.: +49-(0) 271 / 692-0  
Fax.: +49-(0) 271 / 692 - 300  
[www.dometic.de/caravan](http://www.dometic.de/caravan)